

# Chapter 7 Related Documents

## 7.1 Development Views, Sectional Views

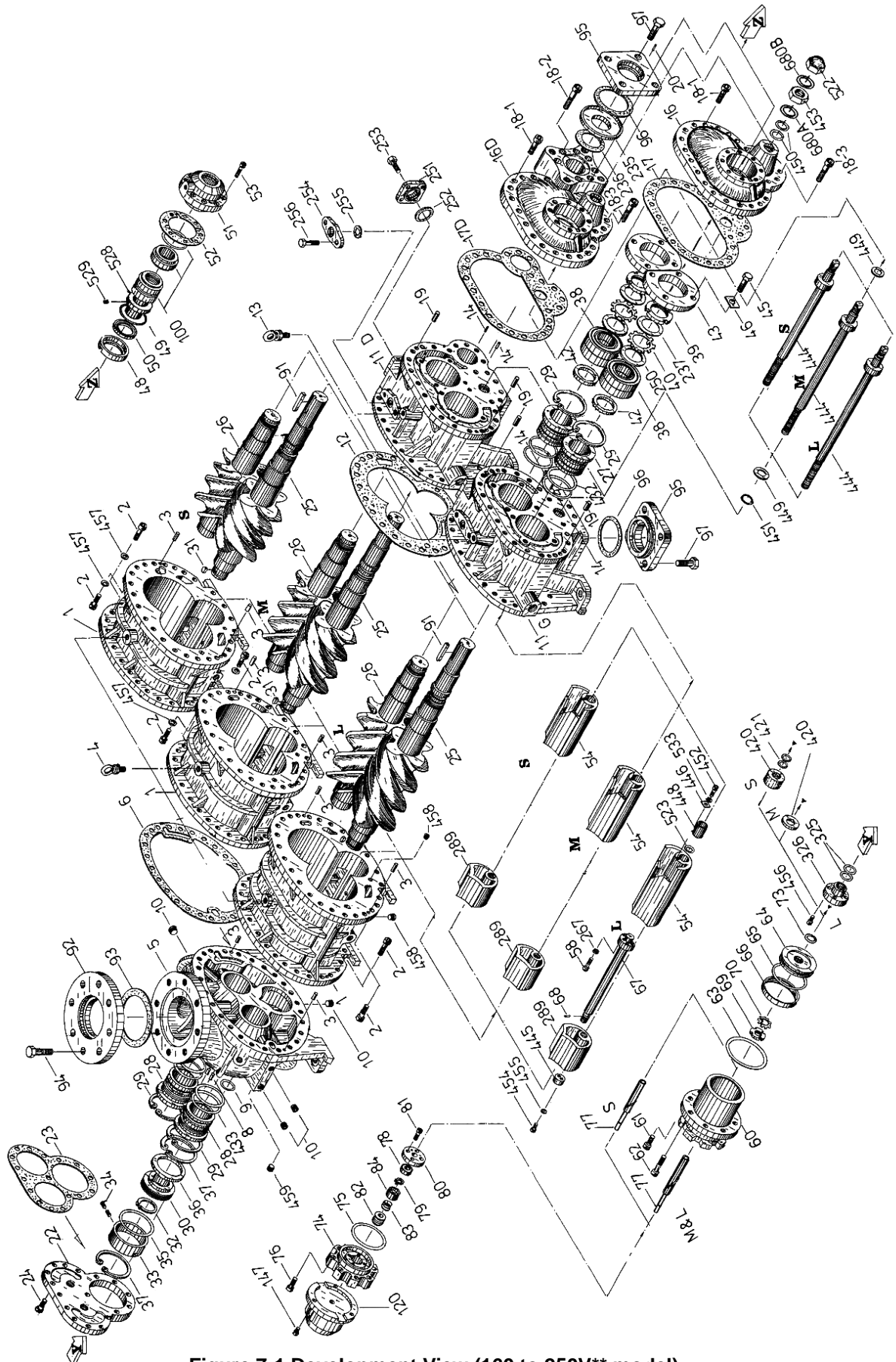

Figure 7-1 Development View (160 to 250V\*\* model)

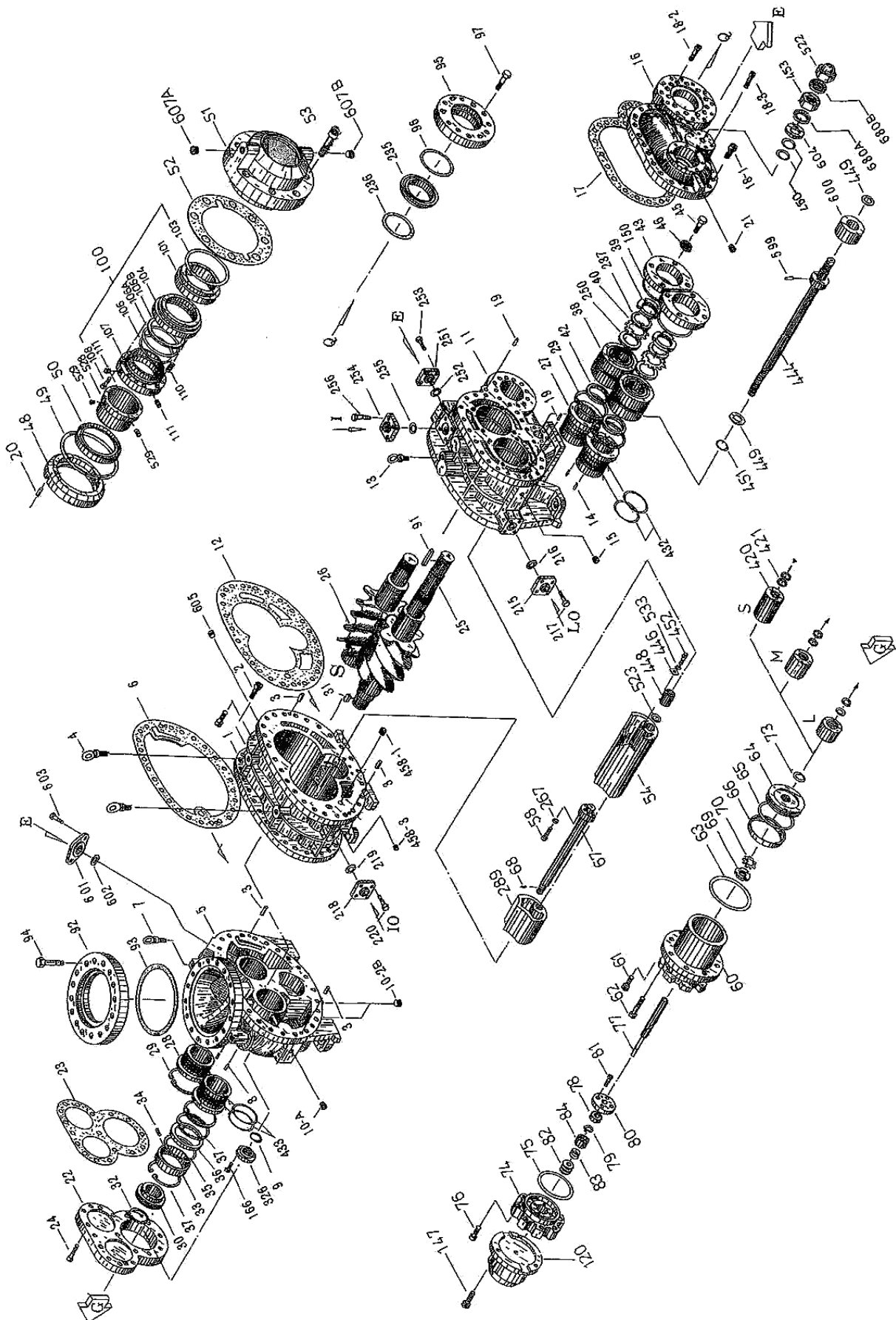

Figure 7-2 Development View (320V\*D model)

## 7.2 Parts Configuration Table

Table 7-1 Parts Configuration Table of 160V\*\* models

P/N	Part Name	Code No.	Remarks	Q'ty.
1	Main Rotor Casing	CS00100-160VXL	160VS*	1 (VS*)
1	Main Rotor Casing	CS00100-160VXS	160VM*	1 (VM*)
1	Main Rotor Casing	CS00100-160VXM	160VL*	1 (VL*)
2	Hexagon Socket Head Cap Screw	NB35412-040	M12 x 40	52
3	Alignment Pin	NE2013-040	Φ13 x 40	4
4	Eye Bolt	NB600-16	M16	1
5	Suction Cover	CS00500-160VX	160V**	1
6	Gasket, Suction Cover	CS00601-160VN	160LDV	1
8	Spring Pin	NE3204-010	Φ4 x 10	2
9	O-ring	PA11-046	JIS B 2401 P46	1
10	A Plug	NF06-008	R 1/4	1
10	B Plug	NF06-008	R 1/4	1
10	C Plug	NF06-010	R 3/8	1
10	D Plug	NF06-010	R 3/8	1
11	Bearing Head	CS01100-160VXG	160V**	1 (V*D)
11	Bearing Head	CS01100-160VXD	160V*G	1 (V*G)
12	Gasket, Bearing Head	CS01200-160VN	160***	1
13	Eye Bolt	NB600-12	M12	1
14	Spring Pin	NE3204-010	Φ4 x 10	2
16	Bearing Cover	CS01600-160VXG	160V**	1 (V*D)
16	Bearing Cover	CS01600-160VXD	160V*G	1 (V*G)
17	Gasket, Bearing Cover (D)	CS01700-160VG	160V**	1 (V*D)
17	Gasket, Bearing Cover (G)	CS01700-160VD	160V*G	1 (V*G)
18	1 Hexagon Socket Head Cap Screw	NB35412-040	M12 x 40	19 (V*D) 24 (V*G)
18	2 Hexagon Socket Head Cap Screw	NB35412-080	M12 x 80	7 (V*D)
19	Alignment Pin	NE2010-040	Φ10 x 40	2
20	Spring Pin	NE3203-010	Φ3 x 10	1
22	Balance Piston Cover	CS02200-160VX	160V**	1
23	Gasket, Balance Piston Cover	CS02300-160N	160*	1
24	Hexagon Socket Head Cap Screw	NB35410-025	M10 x 25	11
25	Male Rotor	CS02500-160VS	160VS*	1 (VS*)
26	Female Rotor			
25	Male Rotor	CS02500-160VM	160VM*	1 (VM*)
26	Female Rotor			
25	Male Rotor	CS02500-160VL	160VL*	1 (VL*)
26	Female Rotor			
27	Main Bearing O-ring type	CS0270-DRT	160***	2
28	Side Bearing O-ring type	CS0280-DRT	160***	2
29	Snap Ring (Internal)	NG11-102	H102	4
30	Balance Piston	CS03000-160H	160**H	1
31	Key, Balance Piston	CS03100-160	160**	1
32	Snap Ring (External)	NG12-050	S50	1
33	Sleeve, Balance Piston	CS03300-160H	160**H	1
34	Set Screw	NA83606-015	M6 x 15	2
35	O-ring	PA12-095	JIS B 2401 G95	1
36	O-ring Spacer	CS03600-160	160***	1
37	Snap Ring (Internal)	NG11-102	H102	2

P/N	Part Name	Code No.	Remarks	Q'ty.
38	Thrust Bearing	CS03800-160P	7212B	2
39	Lock Nut	NG31-012	AN12	2
40	Lock Washer	NG32-012	AW12	2
41	Spacer, Thrust Bearing Outer Race	CS04100-160	160***	2
42	Spacer, Thrust Bearing Alignment	CS04200-160	160***	2
43	Thrust Bearing Gland	CS04300-160	160***	2
45	Hexagon Head Bolt	NB15510-030	M10 x 30	8
46	Conical Spring Washer	ND150-010	M10	8
46	Lock Washer Set (old, plate type)	CS0469-D	160*** 8ps/set	-
48	Retainer, Oil Seal	CS04800-160	160***	1
49	O-ring	PA12-090	JIS B 2401 G90	1
50	Oil Seal	CS05010-160VD	SA1J55 x 70 x 9	1
51	Seal Cover	CS051000-160BBS	160***	1
52	Gasket, Seal Cover	CS05200-160N	160***	1
53	Hexagon Socket Head Cap Screw	NB35408-025	M8X25	8
54	Unloader Slide Valve	CS05400-160VLD	160VS*	1 (VS*)
54	Unloader Slide Valve (with groove)	-	160VS*	1 (VS*)
54	Unloader Slide Valve	CS05400-160VSD	160VM*	1 (VM*)
54	Unloader Slide Valve (with groove)	-	160VM*	1 (VM*)
54	Unloader Slide Valve	CS05400-160VMD	160VL*	1 (VL*)
54	Unloader Slide Valve (with groove)	-	160VL*	1 (VL*)
58	Hexagon Socket Head Cap Screw	NB35406-030	M6 x 30	5
60	Unloader Cylinder	CS06000-160VX	160V**	1
61	Hexagon Socket Head Cap Screw	NB35410-025	M10 x 25	2
62	Hexagon Socket Head Cap Screw	NB35410-065	M10 x 65	6
63	O-ring	PA12-125	JIS B 2401 G125	1
64	Unloader Piston	CS06400-160D	160***	1
65	O-ring	PA11-100	JIS B 2401 P100	1
66	Teflon Cap Seal	CS06600-160	CAP-1BE100	1
67	Push Rod, Unloader Slide Valve	CS06700-160VD	160V**	1
68	Guide Pin	NE2503-008	Φ3 x 8	1
69	Lock Nut	NG31-005	AN05	1
70	Lock Washer	NG32-005	AW05	1
73	O-ring	PA11-021	JIS B 2401 P21	1
74	Unloader Cover	CS07400-160	160*	1
75	O-ring	PA12-110	JIS B 2401 G110	1
76	Hexagon Socket Head Cap Screw	NB35408-025	M8 x 25	8
77	Indicator Cam	CS07700-160VXML	160VS*	1 (VS*)
77	Indicator Cam	CS07700-160VXS	160VM*160VL*	1 (VM*) 1 (VL*)
78	Ball Bearing	CS07800-200	#6000	1
79	Snap Ring (External)	NG12-010	S10	1
80	Bearing Gland	CS08000-200	200***	1
81	Hexagon Socket Head Cap Screw	NB35406-015	M6 x 15	3
82	V-ring	CS08200-200B	20 x 10 x 12	1
83	Spring	CS08300-200	200***	1
84	Retainer, Indicator Cam Spring	CS08400-200	200***	1

P/N	Part Name	Code No.	Remarks	Q'ty.
91	Shaft Key	CS09100-160	160***	1
92	Suction Flange	CS71400-125MK	MYK125A	1
93	Gasket, Suction Flange	CR72000-125N	MYK125A	1
94	Hexagon Head Bolt	NB12020-055	M20 x 55	8
95	Discharge Flange without hole	CS71400-P100CD	MYK100CD	1 (V*D)
95	Discharge Flange with hole	CS71400-100CDMK	MYK100CD	1 (V*D)
95	Discharge Flange without hole	-	MYK100A Female	1
95	Discharge Flange with hole	CS74100-100	MYK100A Female	1
96	Gasket, Discharge Flange (for the case V*G model or V*D model used No.235)	CR72000-100N	MYK100A	1
97	Hexagon Head Bolt (for the case that is not using No.235 Discharge flange spacer)	NB12022-055	M22 x 55	4
97	Hexagon Head Bolt (for the case using No.235 Discharge flange spacer)	NB12022-080	M22 x 80	4
100	Mechanical Seal Assembly	CS10000-160BT	160V** BOS Type	1
100	Mechanical Seal Assembly	CS10002-160EBS	BBS-E	1
120	Unloader Indicator Assembly	CS12000-200VXF	V-series 0-100%	1
125	Micro-Switch	CS12500-200	200*** Z15GW	2
127	Micro-Switch Cam	CS1279-200V	200VS\L	1
129	Wire wound type Potentiometer	CS1299-E10	with Wires	1
129	Conductive Plastic type Potentiometer	CS12919-E10	with Wires	-
137	Indicator Dial	CS13700-200VD	200VL*	1
235	Spacer, Discharge Flange (This spacer is not necessary for CD flange.)	FX101-160		1 (V*D)
236	Gasket, Discharge Flange Spacer	CS23600-160N		1 (V*D)
237	Torsional Slip Washer	CS23700-160	160***	2
250	Thrust Washer	CS25000-160	160***	2
251	Electromizer (Economizer) Flange	CR74000-025	MYK25A	1
252	Gasket, Electromizer (Economizer) Flange	CR72000-025N		1
253	Hexagon Head Bolt	NB15512-035	M12 x 35	4
254	Liquid Injection (Aquamizer) Flange	CR74000-020	MYK20A	1
255	Gasket, Liquid Injection Flange	CR72000-020N		1
256	Hexagon Head Bolt	NB15512-035	M12 x 35	2
267	Special Spring Washer	ND330-06	M6	5
289	Variable Vi auxiliary Slide Valve	CS28900-160VLD	160VS*	1 (VS*)
289	Variable Vi auxiliary Slide Valve	CS28900-160VSD	160VM*	1 (VM*)
289	Variable Vi auxiliary Slide Valve	CS28900-160VMD	160VL*	1 (VL*)
325	O-ring	PA11-030	JIS B 2401 P30	2
326	O-ring Gland	CS32600-160VD		1
420	Spacer, Unloader Positioning	CS42000-160VSD	160VS*	1 (VS*)
420	Spacer, Unloader Positioning	CS42000-160VMD	160VM*	1 (VM*)
421	O-ring	PA11-030	JIS B 2401 P30	1 (VS*)
432	O-ring	PA12-085	JIS B 2401 G85	4
433	O-ring	PA12-085	JIS B 2401 G85	4
444	Vi Adjusting Rod	CS44400-160VLD	160VS*	1 (VS*)
444	Vi Adjusting Rod	CS44400-160VSD	160VM*	1 (VM*)
444	Vi Adjusting Rod	CS44400-160VMD	160VL*	1 (VL*)
445	Lock Washer, Variable Vi Auxiliary Slide Valve	CS44500-160VD	160V**	1
446	Vi Square Washer, Teflon Bushing	CS44600-160VD		1

P/N	Part Name	Code No.	Remarks	Q'ty.
448	Teflon Bushing	CS44800-160VD		1
449	Thrust Washer	CS44900-160VD		2
450	O-ring	PA11-025	JIS B 2401 P25	2
451	O-ring	PA11-025	JIS B 2401 P25	1
452	Hexagon Socket Head Cap Screw	NB35404-010	M4 x 10	1
453	Hexagon Nut	NC720-24	M24	1
454	Hexagon Socket Head Cap Screw	NB35404-020	M4 x 20	1
455	Spring Washer, Hexagon Socket Head Cap Screw	ND330-04	M4	1
456	Hexagon Socket Head Cap Screw	NB35405-010	M5 x 10	2
458	Plug	NF06-004	R 1/8	4
459	Plug	NF06-015	R 1/2	1
522	Domed Cap Nut	NC921-24	M24	1
523	O-ring	PA11-025	JIS B 2401 P25	1
533	Spring Washer, Hexagon Socket Head Cap Screw	ND330-04	M4	1
605	Plug	NF06-015	R 1/2	1
607	A Plug	NF06-008	R 1/4	1
607	B Plug	NF06-008	R 1/4	1
607	C Plug	NF06-008	R 1/4	1
680	A Conical Spring Washer, Vi Adjusting Rod	ND160-024	M24	1
680	B Conical Spring Washer, Vi Adjusting Rod	ND160-024	M24	1

### CAUTION

- The part code of the O-ring is the one assigned to NBR which is standard material. When the material of the O-ring is other than NBR, a different part code is used for each material.  
If you are using O-rings made from other than the standard material, please contact MAYEKAWA when placing an order.

### CAUTION

- The Code No. of parts shown in parentheses below is applied to the product until the end of November, 2014:  
(P/N 120 Unloader Indicator Assembly, P/N 125 Micro-Switch, P/N 129 Potentiometer)
- For the Code No. of new type indicator part, refer to the separately dedicated Instruction manual for it.

Table 7-2 Parts Configuration Table of 200V\*\* models

P/N	Part Name	Code No.	Remarks	Q'ty.
1	Main Rotor Casing	CS00100-200VXS	200VS*	1 (VS*)
1	Main Rotor Casing	CS00100-200VXM	200VM*	1 (VM*)
1	Main Rotor Casing	CS00100-200VXL	200VL*	1 (VL*)
2	Hexagon Socket Head Cap Screw	NB35416-050	M16X50	50
3	Alignment Pin	NE2016-055	Φ16X55	4
4	Eye Bolt	NB600-20	M24	1
5	Suction Cover	CS00500-200VX	200V**	1
6	Gasket, Suction Cover	CS00601-200VN	200***	1
8	Spring Pin	NE3206-012	Φ6X12	2
9	O-ring	PA12-060	JIS B 2401 G60	1
10	A Plug	NF06-010	R3/8	1
10	B Plug	NF06-008	R1/4	1
10	C Plug	NF06-015	R1/2	1
10	D Plug	NF06-015	R1/2	1
11	Bearing Head	CS01100-200VXD	200V**	1 (V*D)
11	Bearing Head	CS01100-200VXG	200V*G	1 (V*G)
12	Gasket, Bearing Head	CS01200-200N	200***	1
13	Eye Bolt	NB600-12	M12	1
14	Spring Pin	NE3206-012	Φ6X12	2
16	Bearing Cover	CS01600-200VXD	200V**	1 (V*D)
16	Bearing Cover	CS01600-200VXG	200V*G	1 (V*G)
17	Gasket, Bearing Cover (D)	CS01700-200VD	200V**	1 (V*D)
17	Gasket, Bearing Cover (G)	CS01700-200VG	200V*G	1 (V*G)
18	1 Hexagon Socket Head Cap Screw	NB35416-050	M16X50	15 (V*D) 18 (V*G)
18	2 Hexagon Socket Head Cap Screw	NB35416-075	M16X75	8 (V*D)
18	3 Hexagon Socket Head Cap Screw	NB35416-065	M16X65	6
19	Alignment Pin	NE2010-050	Φ10X50	2
20	Spring Pin	NE3203-010	Φ3X10	1
21	Plug	NF06-004	R1/8	1
22	Balance Piston Cover	CS02200-200VX	200V**	1
23	Gasket, Balance Piston Cover	CS02300-200N	200V**	1
24	Hexagon Socket Head Cap Screw	NB35412-030	M12X30	11
25	Male Rotor	CS02500-200VS	200VS*	1
26	Female Rotor			
25	Male Rotor	CS02500-200VM	200VM*	1
26	Female Rotor			
25	Male Rotor	CS02500-200VL	200VL*	1
26	Female Rotor			
27	Main Bearing O-ring type	CS0270-ERT	200***	2
28	Side Bearing O-ring type	CS0280-ERT	200***	2
29	Snap Ring (Internal)	NG11-130	H130	4
30	Balance Piston	CS03000-200H	200**LDH	1
31	Key, Balance Piston	CS03100-200	200V**	1
32	Snap Ring (External)	NG12-065	S65	1
33	Sleeve, Balance Piston	CS03300-200H	200**H	1
34	Set Screw	NA83608-015	M8X15	2
35	O-ring	PA11-120	JTS B 2401 P120	1
36	O-ring Spacer	CS03600-200	200***	1

P/N	Part Name	Code No.	Remarks	Q'ty.
37	Snap Ring (Internal)	NG11-130	H130	2
38	Thrust Bearing	CS03800-200P	200*** PPS	2
39	Lock Nut	NG31-013	AN13	2
40	Lock Washer	NG32-013	AW13	2
41	Spacer, Thrust Bearing Outer Race	CS04100-200	200***	2
42	Spacer, Thrust Bearing Alignment	CS04200-200	200***	2
43	Thrust Bearing Gland	CS04300-200	200***	2
45	Hexagon Head Bolt	NB15512-035	M12X35	8
46	Conical Spring Washer	ND150-012	M12 1L	8
46	Lock Washer Set (old, plate type)	CS0469-E	200*** 8p./set	-
48	Retainer, Oil Seal	CS04800-200VD	200V**	1
49	O-ring	PA12-115	JIS B 2401 G115	1
50	Oil Seal	CS05010-200VD	SA1J65x85x12	1
51	Seal Cover	CS051000-200BBS	200V**	1
52	Gasket, Seal Cover	CS05200-200N	200V**	1
53	Hexagon Socket Head Cap Screw	NB35410-025	M10X25	8
54	Unloader Slide Valve	CS05400-200VSD	200VS*	1 (VS*)
54	Unloader Slide Valve (with groove)	-	200VS*	1 (VS*)
54	Unloader Slide Valve	-	200VS* K-port	1 (VS*)
54	Unloader Slide Valve	CS05400-200VMD	200VM*	1 (VM*)
54	Unloader Slide Valve (with groove)	-	200VM*	1 (VM*)
54	Unloader Slide Valve	CS05400-200VLD	200VL*	1 (VL*)
54	Unloader Slide Valve (with groove)	-	200VL*	1 (VL*)
58	Hexagon Socket Head Cap Screw	NB35408-045	M8X45	5
60	Unloader Cylinder	CS06000-200VX	200V**	1
61	Hexagon Socket Head Cap Screw	NB35412-030	M12X30	2
62	Hexagon Socket Head Cap Screw	NB35412-075	M12X75	6
63	O-ring	PA12-150	JIS B 2401 G150	1
64	Unloader Piston	CS06400-200D	200***	1
65	O-ring	PA11-125	JTS B 2401 P125	1
66	Teflon Cap Seal	CS06600-200	CAP-3BE125	1
67	Push Rod, Unloader Slide Valve	CS0671-EV	200V**	1
68	Guide Pin	NE2505-012	Φ5X12	1
69	Lock Nut	NG31-007	AN07	1
70	Lock Washer	NG32-007	AW07	1
73	O-ring	PA12-030	JIS B 2401 G30	1
74	Unloader Cover	CS07400-200	200***	1
75	O-ring	PA12-135	JIS B 2401 G135	1
76	Hexagon Socket Head Cap Screw	NB35410-025	M10X25	8
77	Indicator Cam	CS07700-200VXS	200VS*	1 (VS*)
77	Indicator Cam	CS07700-200VXML	200VM* 200VL*	1 (VM*) 1 (VL*)
78	Ball Bearing	CS07800-200	#6000	1
79	Snap Ring (External)	NG12-010	S10	1
80	Bearing Gland	CS08000-200	200V**	1
81	Hexagon Socket Head Cap Screw	NB35406-015	M6X15	3
82	V-ring	CS08200-200B	20X10X12	1



P/N	Part Name	Code No.	Remarks	Q'ty.
83	Spring	CS08300-200	200V**	1
84	Retainer, Indicator Cam Spring	CS08400-200	200***	1
91	Shaft Key	CS09100-200	200***	1
92	Suction Flange without hole	CS71400-P150	MYK150A(6")	1
93	Gasket, Suction Flange	CR72000-150N	MYK150A	1
94	Hexagon Head Bolt	NB12022-055	M22X55	8
95	Discharge Flange without hole	-	MYK125A Female	1
95	Discharge Flange with hole	CS74100-125	MYK125A Female	1
95	Discharge Flange without hole	CS71400-P125CD	MYK125CD	1 (V*D)
95	Discharge Flange with hole	CS71400-125CDMK	MYK125CD	1 (V*D)
96	Gasket, Discharge Flange (for the case V*G model or V*D model used No.235)	CR72000-125N	MYK125A	1
97	Hexagon Head Bolt (for the case that is not using No.235 Discharge flange spacer)	NB12020-055	M20X55	8
97	Hexagon Head Bolt (for the case using No.235 Discharge flange spacer)	NB12020-080	M20X80	8
100	Mechanical Seal Assembly	CS10002-200EBS	200BBSE	1
100	Mechanical Seal Assembly	CS10000-200BE	200*** BOS TYPE	-
120	Unloader Indicator Assembly	CS12000-200VXF	V-series 0-100%	1
125	Micro-Switch	CS12500-200	200*** Z15GW	2
127	Micro-Switch Cam	CS1279-200V	200VS\L	1
129	Wire wound type Potentiometer	CS1299-E10	with wires	1
129	Conductive Plastic type Potentiometer	CS12919-E10	with wires	-
137	Indicator Dial	CS13700-200VD	200V** L,M,H-port	1
215	Flange, Lubricating Oil inlet (Journal) with hole	CR74000-020	MM(MYK) 20A(3/4")	1
216	Gasket, Lubricating Oil inlet Flange	CR72000-020N	MYK20A	1
217	Hexagon Head Bolt	NB15512-035	M12 X35	2
235	Spacer, Discharge Flange (This spacer is not necessary for CD flange.)	FX101-200	200V**	1 (V*D)
236	Gasket, Discharge Flange Spacer	CS23600-200N	200V**	1 (V*D)
237	Torsional Slip Washer	CS23700-200	200***	2
250	Thrust Washer	CS25000-200	200***	2
251	Electromizer (Economizer) Flange with hole	CR74000-032	MM(MYK) 32A(1"1/4)	1
252	Gasket, Electromizer (Economizer) Flange	CR72000-032N	MYK32A	1
253	Hexagon Head Bolt	NB15512-040	M12X40	4
254	Liquid Injection (Aquamizer) Flange	CR74000-025	MM(MYK) 25A(1")	1
255	Gasket, Liquid Injection Flange	CR72000-025N	MYK25A	1
256	Hexagon Head Bolt	NB15512-035	M12X35	4
267	Special Spring Washer, Hexagon Socket Head Cap Screw	ND330-08	M8	5
289	Variable Vi auxiliary Slide Valve	CS28900-200VSD	200VS*	1 (VS*)
289	Variable Vi auxiliary Slide Valve	CS28900-200VMD	200VM*	1 (VM*)
289	Variable Vi auxiliary Slide Valve	CS28900-200VLD	200VL*	1 (VL*)
325	O-ring	PA11-040	JIS B 2401 P40	2
326	O-ring Gland	CS32600-200VD	200V**	1
420	Spacer, Unloader Positioning	CS42000-200VSD	200VS*	1 (VS*)
420	Spacer, Unloader Positioning	CS42000-200VMD	200VM*	1 (VM*)
421	O-ring	PA11-040	JIS B 2401 P40	2 (VS*)
432	O-ring	PA62-022	AS568A-244	4
433	O-ring	PA62-022	AS568A-244	4

P/N	Part Name	Code No.	Remarks	Q'ty.
444	Vi Adjusting Rod	CS44400-200VSD	200VS*	1 (VS*)
444	Vi Adjusting Rod	CS44400-200VMD	200VM*	1 (VM*)
444	Vi Adjusting Rod	CS44400-200VLD	200VL*	1 (VL*)
445	Lock Washer, Variable Vi Auxiliary Slide Valve	CS44500-200VD	200V**	1
446	Vi Square Washer, Teflon Bushing	CS44600-200VD	200V**	1
448	Teflon Bushing	CS44800-200VD	200V**	1
449	Thrust Washer	CS44900-200VD	160V** to 320VD	2
450	O-ring	PA11-035	JIS B 2401 P35	2
451	O-ring	PA11-035	JIS B 2401 P35	1
452	Hexagon Socket Head Cap Screw	NB35405-015	M5X15	1
453	Hexagon Nut	NC140-30	M30	1
454	Hexagon Socket Head Cap Screw	NB35406-020	M6X20	1
455	Special Spring Washer, Hexagon Socket Head Cap Screw	ND330-06	M6	1
456	Hexagon Socket Head Cap Screw	NB35405-012	M5X12	2
458	1 Plug	NF06-008	R1/4	1
458	2 Plug	NF06-004	R1/8	3
459	Plug	NF06-020	R3/4	1
522	Domed Cap Nut	NC921-30	M30	1
523	O-ring	PA11-035	JIS B 2401 P35	1
528	Oil Seal Sleeve	CS52810-200VD	200V**	1
528	Oil Seal Sleeve with O-ring	CS52809-200VD	200V**	1
529	Set screw	NA83606-008	M6X8	2
533	Spring Washer, Hexagon Socket Head Cap Screw	ND320-005	M5	1
605	Plug	NF06-020	R3/4	1
607	A Plug	NF06-008	R1/4	1
607	B Plug	NF06-008	R1/4	1
680	A Conical Spring Washer, Vi Adjusting Rod	ND160-030	M30 Type	1
680	B Conical Spring Washer, Vi Adjusting Rod	ND160-030	M30 Type	1
715	Cover Plate, Lubricating oil inlet Flange	CS71500-020	20A	1
715	Cover Plate, Economizer inlet Flange	CS71500-032	32A	1
715	Cover Plate, Liquid injection Flange	CS71500-025	25A	1
744	O-ring	PA12-060	JIS B 2401 G60	1

### CAUTION

- The part code of the O-ring is the one assigned to NBR which is standard material. When the material of the O-ring is other than NBR, a different part code is used for each material.  
If you are using O-rings made from other than the standard material, please contact MAYEKAWA when placing an order.

### CAUTION

- The Code No. of parts shown in parentheses below is applied to the product until the end of November, 2014:  
(P/N 120 Unloader Indicator Assembly, P/N 125 Micro-Switch, P/N 129 Potentiometer)
- For the Code No. of new type indicator part, refer to the separately dedicated Instruction manual for it.

Table 7-3 Parts Configuration Table of 250V\*\* models

P/N	Part Name	Code No.	Remarks	Q'ty.
1	Main Rotor Casing	CS00100-250VXS	250VS*	1 (VS*)
1	Main Rotor Casing	CS00100-250VXM	250VM*	1 (VM*)
1	Main Rotor Casing	CS00100-250VXL	250VL*	1 (VL*)
1	Main Rotor Casing	-	250VLL*	1 (VLLD)
2	Hexagon Socket Head Cap Screw	NB35420-060	M20×60	44
3	Alignment Pin	NE2016-070	Φ16×70	4
4	Eye Bolt	NB600-30	M30	1
5	Suction Cover	CS00500-250VX	250V**	1
5	Suction Cover	-	250VW*	1 (VLLD)
6	Gasket, Suction Cover	CS00601-250VN	250***	1
7	Eye Bolt	NB600-12	M12	2
8	Spring Pin	NE3206-012	Φ6×12	2
9	O-ring	PA12-065	JIS B 2401 G65	1
10	A Plug	NF06-010	R3/8	1
10	B Plug	NF06-008	R1/4	1
10	C Plug	NF06-020	R3/4	1
10	D Plug	NF06-015	R1/2	1
11	Bearing Head	CS01100-250VXD	250V**	1 (V*D)
11	Bearing Head	CS01100-250VXG	250V*G	1 (V*G)
12	Gasket, Bearing Head	CS01200-250N	250***	1
13	Eye Bolt	NB600-12	M12	1
14	Spring Pin	NE3206-012	Φ6×12	2
16	Bearing Cover	CS01600-250VXD	250V**	1 (V*D)
16	Bearing Cover	CS01600-250VXG	250V*G	1 (V*G)
17	Gasket, Bearing Cover (D)	CS01700-250VD	250V**	1 (V*D)
17	Gasket, Bearing Cover (G)	CS01700-250VG	250V*G	1 (V*G)
18	1 Hexagon Socket Head Cap Screw	NB35416-050	M16×50	18 (V*D) 22 (V*G)
18	2 Hexagon Socket Head Cap Screw	NB35416-090	M16×90	8 (V*D)
18	3 Hexagon Socket Head Cap Screw	NB35416-070	M16×70	5
19	Alignment Pin	NE2010-050	Φ10×50	2
20	Spring Pin	NE3203-010	Φ3×10	1
21	Plug	NF06-004	R1/8	1
22	Balance Piston Cover	CS02200-250VX	250V**	1
23	Gasket, Balance Piston Cover	CS02300-250N	250***	1
24	Hexagon Socket Head Cap Screw	NB35412-030	M12×30	11
25	Male Rotor	CS02500-250VS	250VS*	1 (VS*)
26	Female Rotor			
25	Male Rotor	CS02500-250VM	250VM*	1 (VM*)
26	Female Rotor			
25	Male Rotor	CS02500-250VL	250VL*	1 (VL*)
26	Female Rotor			
27	Main Bearing O-ring type	CS0270-FRT	250***	2
28	Side Bearing O-ring type	CS0280-FRT	250***	2

P/N	Part Name	Code No.	Remarks	Q'ty.
29	Snap Ring (Internal)	NG11-160	H160	4
30	Balance Piston	CS03000-250H	250**H	1
31	Key, Balance Piston	CS03100-250	250***	1
32	Snap Ring (External)	NG12-080	S80	1
33	Sleeve, Balance Piston	CS03300-250H	250**H	1
34	Set Screw	NA83608-020	M8×20	2
35	O-ring	PA11-150	JIS B 2401 P150	1
36	O-ring Spacer	CS03600-250	250***	1
37	Snap Ring (Internal)	NG11-160	H160	2
38	Thrust Bearing	CS03800-250P	250*** PPS	2
39	Lock Nut	NG31-017	AN17	2
40	Lock Washer	NG32-017	AW17	2
42	Spacer, Thrust Bearing Alignment	CS04200-250	250***	2
43	Thrust Bearing Gland	CS04300-250	250***	2
45	Hexagon Head Bolt	NB15516-045	M16×45	8
46	Conical Spring Washer	ND150-016	M16 1L	8
46	Lock Washer Set (old, plate type)	CS0469-F	250*** 8p./set	-
48	Retainer, Oil Seal	CS04800-250VD	250V** BBSIII BBSE BOS	1
49	O-ring	PA12-135	JIS B 2401 G135	1
50	Oil Seal	CS05010-250VD	SA1J 75×100×13	1
51	Seal Cover	CS05100-250BBS	250V** BBSIII BBSE BOS	1
52	Gasket, Seal Cover	CS05200-250N	250***	1
53	Hexagon Socket Head Cap Screw	NB35412-030	M12×30	8
54	Unloader Slide Valve	CS05400-250VSD	250VS*	1 (VS*)
54	Unloader Slide Valve	CS05400-250VMD	250VM*	1 (VM*)
54	Unloader Slide Valve	CS05400-250VLD	250VL*	1 (VL*)
54	Unloader Slide Valve	-	250VLL*	1 (VLLD)
58	Hexagon Socket Head Cap Screw	NB35410-055	M10×55	5
60	Unloader Cylinder	CS06000-250VX	250V**	1
61	Hexagon Socket Head Cap Screw	NB35416-040	M16×40	2
62	Hexagon Socket Head Cap Screw	NB35416-090	M16×90	6
63	O-ring	PA12-190	JIS B 2401 G190	1
64	Unloader Piston	CS06400-250D	250***	1
65	O-ring	PA11-155	JISB2401 1A P155	1
66	Teflon Cap Seal	CS06600-250	SUNR-BE-155	1
67	Push Rod, Unloader Slide Valve	CS06700-250VD	250V**	1
67	Push Rod, Unloader Slide Valve	CS06700-250VLLD	250VLL*	1 (VLLD)
68	Guide Pin	NE2505-012	Φ5×12	1
69	Lock Nut	NG31-008	AN08	1
70	Lock Washer	NG32-008	AW08	1
73	O-ring	PA12-035	JIS B 2401 G35	1
74	Unloader Cover	CS07400-250	250***	1
75	O-ring	PA12-170	JIS B 2401 G170	1

P/N	Part Name	Code No.	Remarks	Q'ty.
76	Hexagon Socket Head Cap Screw	NB35412-030	M12×30	8
77	Indicator Cam	CS07700-250VXS	250VS*	1 (VS*)
77	Indicator Cam	CS07700-250VXML	250VL*/VM*	1 (VM*) 1 (VL*) 1(VLLD)
78	Ball Bearing	CS07800-200	#6000	1
79	Snap Ring (External)	NG12-010	S10	1
80	Bearing Gland	CS08000-200	200V**	1
81	Hexagon Socket Head Cap Screw	NB35406-015	M6×15	3
82	V-ring	CS08200-200B	20×10×12	1
83	Spring	CS08300-200	200V**	1
84	Retainer, Indicator Cam Spring	CS08400-200	200***	1
91	Shaft Key	CS09100-250	250***	1
92	Suction Flange without hole	CS71400-P250	MYK250A Male	1
92	Suction Flange with hole	CS71400-250MK	MYK250A Male	1
93	Gasket, Suction Flange	CS09300-250N	MYK250A	1
94	Hexagon Head Bolt	NB12024-065	M24×65	12
95	Discharge Flange without hole	CS71400-P150CD	MYK150CD Male	1 (*UD)
95	Discharge Flange with hole	CS71400-150CDMK	MYK150CD Male	1 (*UD)
95	Discharge Flange without hole	-	MYK150A Female	1 (*UD)
95	Discharge Flange with hole	CR74100-150	MYK150A Female	1 (*UD)
95	Discharge Flange without hole	CS71400-P150	MYK150A Male	1 (*G)
95	Discharge Flange with hole	CR74000-150	MYK150A Male	1 (*G)
96	Gasket, Discharge Flange (for the case V*G model or V*D model used No.235)	CR72000-150N	MYK150A	1
97	Hexagon Head Bolt (for the case that is not using No.235 Discharge flange spacer)	NB12022-055	M22×55	8
97	Hexagon Head Bolt (for the case using No.235 Discharge flange spacer)	NB12022-085	M22×85	8
100	Mechanical Seal Assembly	CS10000-250BE	BOS-E1	1
100	Mechanical Seal Assembly	CS10002-250EBS	BBS-E	1
120	Unloader Indicator Assembly	CS12000-VXF	V-series 0-100%	1
125	Micro-Switch	CS12500-200	200*** Z15GW	2
127	Micro-Switch Cam	CS1279-200V	200VS\L	1
129	Wire wound type Potentiometer	CS1299-E10	with lead wire	1
129	Conductive Plastic type Potentiometer	CS12919-E10	with lead wire	-
137	Indicator Dial	CS13700-200VD	200V** L,M,H-port	1
137	Indicator Dial	CS13700-200VD	250VLL*	1 (VLLD)
215	Flange, Lubricating Oil inlet (Journal) with hole	CR74000-025	MYK25A Male	1
216	Gasket, Lubricating Oil inlet Flange	CR72000-025N	MYK25A	1
217	Hexagon Head Bolt	NB111012-035	M12×35	4
235	Spacer, Discharge Flange (This spacer is not necessary for CD flange.)	FX101-250	250***	1(V*D)
236	Gasket, Discharge Flange Spacer	CS23600-250N	250***	1(V*D)
237	Torsional Slip Washer	CS23700-250	250***	2
250	Thrust Washer	CS25000-250	250***	2
251	Electromizer (Economizer) Flange without hole	CS71400-050	MYK50A Male	1

P/N	Part Name	Code No.	Remarks	Q'ty.
251	Electromizer (Economizer) Flange with hole	CR74000-050	MYK50A Male	1
252	Gasket. Electromizer (Economizer) Flange	CR72000-050N	MYK50A	1
253	Hexagon Head Bolt	NB111016-045	M16×45	4
254	Liquid Injection Flange with hole	CR74000-032	MYK32A Male	1
255	Gasket, Liquid Injection Flange	CR72000-032N	MYK32A	1
256	Hexagon Head Bolt	NB111012-040	M12×40	4
267	Special Spring Washer, Hexagon Socket Head Cap Screw	ND330-10	M10 TYPE	5
289	Variable Vi auxiliary Slide Valve	CS28900-250VSD	250VS*	1 (VS*)
289	Variable Vi auxiliary Slide Valve	CS28900-250VMD	250VM*	1 (VM*)
289	Variable Vi auxiliary Slide Valve	CS28900-250VLD	250VL*	1 (VL*)
289	Variable Vi auxiliary Slide Valve	-	250VLL*	1 (VLLD)
325	O-ring	PA11-046	JIS B 2401 P46	2
326	O-ring Gland	CS32600-250VD	250V**	1
420	Spacer, Unloader Positioning	CS42000-250VSD	250VS*	1 (VS*)
420	Spacer, Unloader Positioning	CS42000-250VMD	250VM*	1 (VM*)
421	O-ring	PA11-046	JIS B 2401 P46	2 (VS*)
432	O-ring	PA12-130	JIS B 2401 G130	4
433	O-ring	PA12-130	JIS B 2401 G130	4
444	Vi Adjusting Rod	CS44400-250VSD	250VS*	1 (VS*)
444	Vi Adjusting Rod	CS44400-250VMD	250VM*	1 (VM*)
444	Vi Adjusting Rod	CS44400-250VLD	250VL*	1 (VL*)
444	Vi Adjusting Rod	CS44400-250VLL	250VLL*	1 (VLLD)
445	Lock Washer, Variable Vi Auxiliary Slide Valve	CS44500-250VD	200V**	1
446	Vi Square Washer, Teflon Bushing	CS44600-250VD	250V***	1
448	Teflon Bushing	CS44800-250VD	250V**	1
449	Thrust Washer	CS44900-250VD	250V**	2
450	O-ring	PA11-040	JIS B 2401 P40	2
451	O-ring	PA11-040	JIS B 2401 P40	1
452	Hexagon Socket Head Cap Screw	NB35406-020	M6×20	1
453	Hexagon Nut	NC720-36	M36	1
454	Hexagon Socket Head Cap Screw	NB35406-035	M6×35	1
455	Special Spring Washer, Hexagon Socket Head Cap Screw	ND330-06	M6	1
456	Hexagon Socket Head Cap Screw	NB35405-010	M5×12	4
458	1 Plug	NFO6-015	R1/2	1
458	2 Plug	NFO6-004	R1/8	2
458	3 Plug	NFO6-008	R1/4	1
459	Plug	NFO6-015	R1/2	1
522	Domed Cap Nut	NC921-36	M36	1
523	O-ring	PA11-040	JIS B 2401 P40	1
528	Oil Seal Sleeve	CS52810-250VD	250V**	1
528	Oil Seal Sleeve with O-ring	CS52809-250VD	250V**	1
529	Set screw	NA83606-008	M6×8	2
533	Spring Washer, Hexagon Socket Head Cap Screw	ND330-06	M6	1

P/N		Part Name	Code No.	Remarks	Q'ty.
605		Plug	NF06-025	R 1"	1
607	A	Plug	NF06-008	R1/4	1
607	B	Plug	NF06-008	R1/4	1
680	A	Conical Spring Washer, Vi Adjusting Rod	ND160-036	M36	1
680	B	Conical Spring Washer, Vi Adjusting Rod	ND160-036	M36	1
715		Cover Plate, Lubricating oil inlet Flange	CS71500-025	25A	1
715		Cover Plate, Liquid injection Flange	CS71500-032	32A	1
744		O-ring	PA12-070	JIS B 2401 G70	1

**CAUTION**

- The part code of the O-ring is the one assigned to NBR which is standard material. When the material of the O-ring is other than NBR, a different part code is used for each material.  
If you are using O-rings made from other than the standard material, please contact MAYEKAWA when placing an order.

**CAUTION**

- The Code No. of parts shown in parentheses below is applied to the product until the end of November, 2014:  
(P/N 120 Unloader Indicator Assembly, P/N 125 Micro-Switch, P/N 129 Potentiometer)
- For the Code No. of new type indicator part, refer to the separately dedicated Instruction manual for it.

**[POINT]**

The sizes of O-ring No.432-2 and No.432-2 have been changed to G130 from G135 in October 2012 as a design change.

**Table 7-4 Parts Configuration Table of 320V\*D models**

P/N	Part Name	Code No.	Remarks	Q'ty.
1	Main Rotor Casing	CS00100-320VXS	320VS*	1(VSD)
1	Main Rotor Casing	CS00100-320VXM	320VM*	1(VMD)
1	Main Rotor Casing	CS00100-320VXL	320VL*	1(VLD)
2	Hexagon Socket Head Cap Screw	NB35424-080	M24×80	52
3	Alignment Pin	NE2025-080	Φ25×80	4
4	Eye Bolt	NB600-30	M30	2
5	Suction Cover	CS00500-320VXD	320V*D	1
6	Gasket, Suction Cover	CS00600-320VD	320***	1
7	Eye Bolt	NB600-16	M16	2
8	Spring Pin	NE3206-018	Φ6×18	2
9	O-ring	PA11-058	JIS B 2401 P58	1
10	A Plug	NF06-020	R3/4	1
10	B Plug	NF06-015	R1/2	2
11	Bearing Head	CS01100-320VXD	320V*D	1
12	Gasket, Bearing Head	CS01200-320N	320***	1
13	Eye Bolt	NB600-16	M30 (from 2006.03.30)	1
14	Spring Pin	NE3206-018	Φ6×18	2
15	Plug	NF06-010	R 3/8	1
16	Bearing Cover	CS01600-320VXD	320V*D	1
17	Gasket, Bearing Cove	CS01700-320VD	320V*D	1
18	1 Hexagon Socket Head Cap Screw	NB35420-070	M20×70	19
18	2 Hexagon Socket Head Cap Screw	NB35420-120	M20×120	12
18	3 Hexagon Socket Head Cap Screw	NB35420-120	M20×120	6
19	Alignment Pin	NE2016-070	Φ16×70	2
20	Spring Pin	NE3203-016	Φ3×16	1
21	Plug	NF06-008	R1/4	1
22	Balance Piston Cover	CS02200-320	320***	1
23	Gasket, Balance Piston Cover	CS02300-320N	320***	1
24	Hexagon Socket Head Cap Screw	NB35416-045	M16×45	11
25	Male Rotor	CS02500-320VS	320VS*	1(VSD)
25	Female Rotor			
25	Male Rotor	CS02500-320VM	320VM*	1(VMD)
26	Female Rotor			
25	Male Rotor	CS02500-320VL	320VL*	1(VLD)
26	Female Rotor			
27	Main Bearing O-ring type	CS0270-GRT	320***	2
28	Side Bearing O-ring type	CS0280-GRT	320***	2
29	Snap Ring (Internal)	NG11-200	H200	4
30	Balance Piston	CS03000-320H	320**H	1
31	Key, Balance Piston	CS03100-320	320***	1
32	Snap Ring (External)	NG12-100	S100	1



P/N	Part Name	Code No.	Remarks	Q'ty.
33	Sleeve, Balance Piston	CS03300-320H	320**H	1
34	Spring Pin	NE3206-014	Φ6×14	1
35	O-ring	PA12-190	JIS B 2401 G190	1
36	O-ring Spacer	CS03600-320	320***	1
37	Snap Ring (Internal)	NG11-200	H200	2
38	Thrust Bearing	CS03800-320	320***	2
39	Lock Nut	NG31-021	AN21	2
40	Lock Washer	NG32-021	AW21	2
42	Spacer, Thrust Bearing Alignment	CS04200-320	320***	2
43	Thrust Bearing Gland	CS04300-320	320***	2
45	Hexagon Head Bolt	NB15520-055	M20×55	8
46	Conical Spring Washer	ND150-020	M20 1L	8
46	Lock Washer Set (old, plate type)	CS0469-G	320*** 8p./set	-
48	Retainer, Oil Seal	CS04800-320VDS	320***	1
48	Retainer, Oil Seal	CS04800-320P	320*** with Seal pot	1
49	O-ring	PA12-160	JIS B 2401 G160	1
50	Oil Seal	CS05010-320VD	SA1J 95×120×13	1
51	Seal Cover	CS051000-320BBS	320*** BBS, BOS	1
52	Gasket, Seal Cover	CS05200-320N	320***	1
53	Hexagon Socket Head Cap Screw	NB35416-040	M16×40	8
54	Unloader Slide Valve	CS05400-320VSD	320VS*	1(VSD)
54	Unloader Slide Valve	CS05400-320VMD	320VM*	1(VMD)
54	Unloader Slide Valve	CS05400-320VLD	320VL*	1(VLD)
58	Hexagon Socket Head Cap Screw	NB35412-055	M12×55	5
60	Unloader Cylinder	CS06000-320V	320V*D	1
61	Hexagon Socket Head Cap Screw	NB35420-050	M20×50	2
62	Hexagon Socket Head Cap Screw	NB35420-110	M20×110	6
63	O-ring	PA12-240	JIS B 2401 G240	1
64	Unloader Piston	CS06400-320U	320***	1
65	O-ring	PA11-200	JIS B 2401 P200	1
66	Teflon Cap Seal	CS06600-320	CAP-3BE200	1
67	Push Rod, Unloader Slide Valve	CS0671-GV	320V*D	1
68	Guide Pin	NE2506-016	Φ6×16	1
69	Lock Nut	NG31-010	AN10	1
70	Lock Washer	NG32-010	AW10	1
73	O-ring	PA11-044	JIS B 2401 P44	1
74	Unloader Cover	CS07400-320	320***	1
75	O-ring	PA12-210	JIS B 2401 G210	1
76	Hexagon Socket Head Cap Screw	NB35416-040	M16×40	8
77	Indicator Cam	CS07700-320VS	320VS*	1(VSD)
77	Indicator Cam	CS07700-320VM	320VM* 320VL*	1(VMD) 1(VLD)
78	Ball Bearing	CS07800-200	#6000	1

P/N	Part Name	Code No.	Remarks	Q'ty.
79	Snap Ring (External)	NG12-010	S10	1
80	Bearing Gland	CS08000-200	200V**	1
81	Hexagon Socket Head Cap Screw	NB35406-015	M6×15	3
82	V-ring	CS08200-200B	20×10×12 VH10 NBR	1
83	Spring	CS08300-200	200V**	1
84	Retainer, Indicator Cam Spring	CS08400-200	200***	1
91	Shaft Key	CS09100-320	320***	1
92	Suction Flange	CS71400-P350	MYK350A	1
93	Gasket, Suction Flange	CS09300-320N	MYK350A	1
94	Hexagon Head Bolt	NB12024-075	M24×75	16
95	Discharge Flange	CS71400-P200	MYK200A	1
95	Discharge Flange	CS71400-P200CD	MYK200CD	1
96	Gasket, Discharge Flange (for the case V*G model or V*D model used No.235)	CR72000-200N	MYK200A	1
97	Hexagon Head Bolt (for the case that is not using No.235 Discharge flange spacer)	NB12020-055	M20×55	12
97	Hexagon Head Bolt (for the case using No.235 Discharge flange spacer)	NB12020-085	M20×85	12
100	Mechanical Seal Assembly	CS10000-320BE	BOS-E1	-
100	Mechanical Seal Assembly	CS10002-320EBS	BBS-E	1
120	Unloader Indicator Assembly	CS12000-200VXF	200V** 0-100%	1
125	Micro-Switch	CS12500-200	200*** Z15GW	2
127	Micro-Switch Cam	CS1279-200V	200VS\L	1
129	Wire wound type Potentiometer	CS1299-E10	with Wires	1
129	Conductive Plastic type Potentiometer	CS12919-E10	with Wires	-
137	Indicator Dial	CS13700-320VD	320V*D	1
150	O-ring	PA12-220	JIS B 2401 G220	2
166	Hexagon Socket Head Cap Screw	NB35405-010	M5×10	4
215	Flange, Lubricating Oil inlet (Journal) without hole	CS71400-040	MYK40A	1
216	Gasket, Lubricating Oil inlet Flange	CR72000-040N	MYK40A	1
217	Hexagon Head Bolt	NB14012-040	M12×40	4
218	Flange, Oil Injection with hole	CR74000-025	MYK25A	1
219	Gasket, Oil Injection Flange	CR72000-025N	MYK25A	1
220	Hexagon Head Bolt	NB14012-035	M12×35	4
235	Spacer, Discharge Flange (This spacer is not necessary for CD flange.)	-	320***	1
236	Gasket, Discharge Flange Spacer	CS23600-320N	320***	1
237	Torsional Slip Washer	CS23700-320	125~400	2
250	Thrust Washer	CS25000-320	320***	2
251	Electromizer (Economizer) Flange without hole	CS71400-080	MYK80A Male	1
251	Electromizer (Economizer) Flange with hole	CR74000-080	MYK80A Male	1
252	Gasket, Electromizer (Economizer) Flange	CR72000-080N	MYK80A	1
253	Hexagon Head Bolt	NB15520-055	M20×55	4
254	Liquid Injection Flange without hole	CS71400-050	MYK50A Male	1

P/N	Part Name	Code No.	Remarks	Q'ty.
254	Liquid Injection Flange with hole	CR74000-050	MYK50A Male	-
255	Gasket, Liquid Injection Flange	CR72000-050N	MYK50A	1
256	Hexagon Head Bolt	NB15516-045	M16×45	4
267	Special Spring Washer, Hexagon Socket Head Cap Screw	ND330-12	M12	5
289	Variable Vi auxiliary Slide Valve	CS28900-320VSD	320VS*	1(VSD)
289	Variable Vi auxiliary Slide Valve	CS28900-320VMD	320VM*	1(VMD)
289	Variable Vi auxiliary Slide Valve	CS28900-320VLD	320VL*	1(VLD)
326	O-ring Gland	CS32600-320	320***	1
420	Spacer, Unloader Positioning	CS42000-320VSD	320VS*	1(VSD)
420	Spacer, Unloader Positioning	CS42000-320VMD	320VM*	1(VMD)
420	Spacer, Unloader Positioning	CS42000-320VLD	320VL*	1(VLD)
421	O-ring	PA11-058	JIS B 2401 P58	2
432	O-ring	PA12-165	JIS B 2401 G165	4
433	O-ring	PA12-165	JIS B 2401 G165	4
444	Vi Adjusting Rod	CS44400-320VSD	320VS*	1(VSD)
444	Vi Adjusting Rod	CS44400-320VMD	320VM*	1(VMD)
444	Vi Adjusting Rod	CS44400-320VLD	320VL*	1(VLD)
446	Vi Square Washer, Teflon Bushing	CS44600-250VD	250V***	1
448	Teflon Bushing	CS44800-320VD	320V*D	1
449	Thrust Washer	CS44900-320VD	200V**	2
450	O-ring	PA11-044	JIS B 2401 P44	2
451	O-ring	PA11-050A	JIS B 2401 P50A	1
452	Hexagon Socket Head Cap Screw	NB35406-020	M6×20	1
453	Hexagon Nut	NC140-36	M36	1
458	1 Plug	NF06-015	R1/2	1
458	2 Plug	NF06-004	R1/8	2
458	3 Plug	NF06-008	R1/4	1
459	Plug	NF06-015	R1/2	1
522	Domed Cap Nut	NC921-36	M36	1
523	O-ring	PA11-050A	JIS B 2401 P50A	1
528	Oil Seal Sleeve	CS52810-320VD	320***	1
528	Oil Seal Sleeve with O-ring	CS52809-320VD	320***	1
529	Set screw	NA83606-010	M6×8	2
533	Spring Washer, Hexagon Socket Head Cap Screw	ND330-06	M6	1
599	Guide Pin	NE3206-016	Φ6×16	1
600	Retainer, Vi adjusting Rod	CS60000-320VD	320V*D	1
601	Flange, Lubricating Oil inlet (F Rotor side)	CR74000-020	MYK20A	1
602	Gasket, Lubricating Oil inlet (F Rotor side) Flange	CR72000-020N	MYK20A	1
603	Hexagon Head Bolt	NB14012-035	M12×35	2
604	Vi Adjusting Rod Washer	ND160-036	JIS B 1256 36	1
605	Plug	NF06-032	R1 1/4	1
607	A Plug	NF06-004	R1/4	1

P/N		Part Name	Code No.	Remarks	Q'ty.
607	B	Plug	NF06-004	R1/4	1
680	A	Conical Spring Washer, Vi Adjusting Rod	ND160-036	M36	1
680	B	Conical Spring Washer, Vi Adjusting Rod	ND160-036	M36	1
715		Cover Plate, Liquid injection Flange	CS71500-025	MYK25A	1
744		O-ring	PA12-090	JIS B 2401 G90	1

**CAUTION**

- The part code of the O-ring is the one assigned to NBR which is standard material. When the material of the O-ring is other than NBR, a different part code is used for each material.  
If you are using O-rings made from other than the standard material, please contact MAYEKAWA when placing an order.

**CAUTION**

- The Code No. of parts shown in parentheses below is applied to the product until the end of November, 2014:  
(P/N 120 Unloader Indicator Assembly, P/N 125 Micro-Switch, P/N 129 Potentiometer)
- For the Code No. of new type indicator part, refer to the separately dedicated Instruction manual for it.